

# P&G Andover Manufacturing Center Enhancement Project



# Presentation Outline

- Stormwater
- Traffic
- Parking Demand/Shift Analysis/Construction
  - Parking Space Demand Maxima
  - Construction Parking Plan
  - Construction Period Parking Route
- Landscaping
  - Existing Exterior Landscape
  - Existing Employee Tables/Shade
- Environment
- Q&A and Next Steps



# Stormwater

- Planning Board and Conservation Commission Deposits Have Been Paid
- Awaiting Report from Horsley Witten Group
- Prepared to Respond to Any Questions

# Traffic

- Planning Board Deposit Has Been Paid
- Received Initial Report from Greenman-Pederson, Inc. this PM.
- Have Not Had Discussion Amongst the Gillette Team Yet.
- Prepared to Respond to Any Questions Board feels it needs answered tonight.

# Parking Space Demand Maxima

- Current used spaces = 225 Spaces
  - Construction peak = 265 Spaces
  - Post-Construction = 435 Spaces
  - Reflects “Worst Case” Assumptions
    - Employee Counts
    - Shift Schedules
    - Shift Overlaps
  - Totals Includes Employees, Contractors, Construction Personnel and Visitors
  - Up to 654 Spaces Available
- 490 Spaces

# Construction Parking Plan

SKANSKA

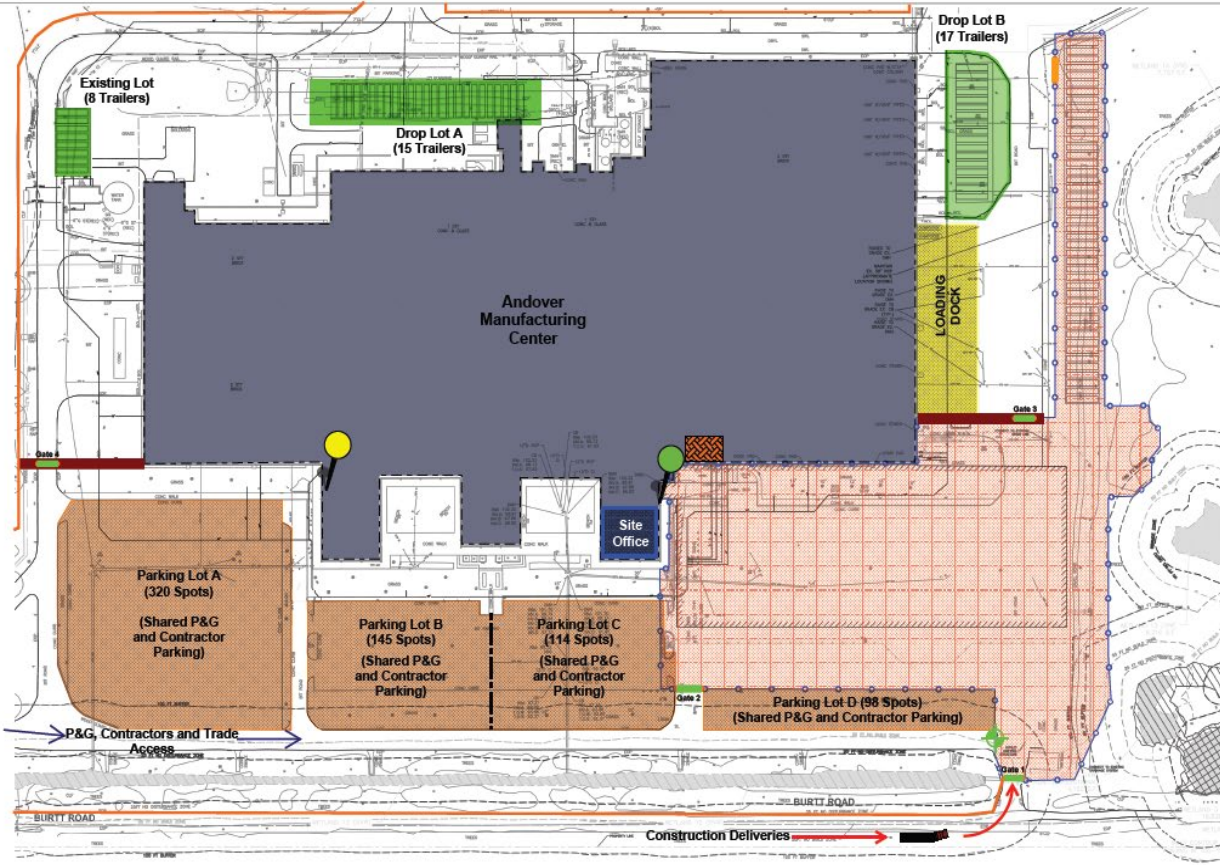

## Legend

- Existing Fence
- Construction Gate
- Relocated Plant Entrance
- Existing Plant Entrance
- Till site Waste Enclosure
- Break Area

## Notes

- Total Parking Count 677 Spots
- Total Trailer Count 73 Spots

Principio

# Construction Period Traffic Route

## SKANSKA



# Existing Landscaping



# Existing Landscaping

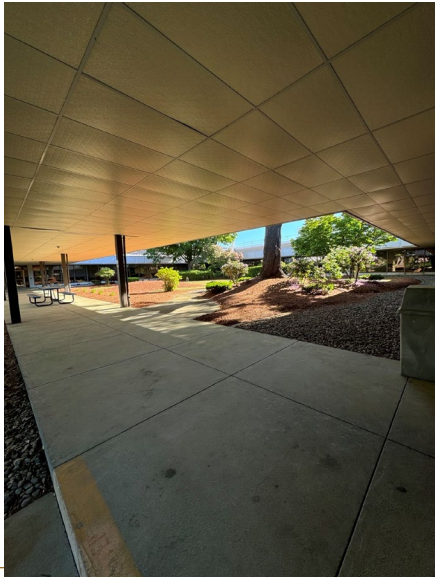

# Air Emissions Permitting

MA DEP review; draft air quality approval issued 6/5/24

- Site is Non-Major Air Emissions Source
  - Remain a Non-Major source with project
  - Continued compliance with all regulations
  - Best Available Control Technology applied
- Public Comment Through 7/5/24

# Emergency Generator

- Expansion Will Include One Emergency Generator
  - Ultra-low Sulfur Diesel-Fuel
  - Emergency/Testing Operations Only
  - Operate < 100 hours/year (maintenance & test)
- Included in MA DEP “Environmental Results Program” with pre-approved best available emissions performance and certification.
- Meet all MA DEP and USEPA emissions reduction standards

# Water & Wastewater

- Project water usage
  - Modest project water usage and water discharge
  - Expect less than historical highest site usage (sustainability improvements)
- Modeled by Andover Utilities – no adverse impact to water system
- GLSD approval of effluent required (Jul through Sept Follow-up)

# Q&A and Next Steps

- Q&A

- Next Steps